

Flyin MPO Optical Patch Cord

Fiber optic patch cord is used for linking the equipment and components in fiber optic network, is comprised of a polymer outer body and inner assembly fitted with a precision alignment mechanism. The combination of a ceramic/phosphor bronze alignment sleeves and precision molded polymer housing provides consistent long-term mechanical and optical performance.

Flyin Optronics offer kinds of fiber patch cord, such as FC, SC, ST, LC, MU, MTRJ, MPO, E2000 series, available for PC/UPC/APC version, provide with SM, MM, OM3 fiber cable, simplex and duplex types, 0.9mm, 2.0mm, 3.0mm cable diameter for choose, different fiber length by customers request.

Features

- MPO connector complied with IEC-61754-7
- A quick-to-deploy
- Scalable solution
- High compatibility, flexibility& system performance
- Lower installation cost

Applications

- SAN (Storage Area Network)Data Center LAN
- LAN/SAN switch Equipment Distribution Area(EDA)
- Emerging 40G and 100G Protocols

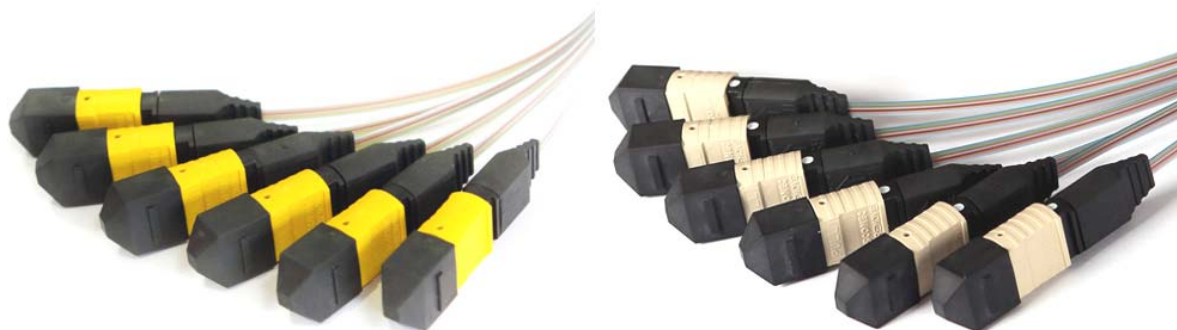

Performance Specifications

MPO Connector		Standard		Low Loss		Standard		Low Loss	
		SM MT Ferrule		SM MT Ferrule		MM MT Ferrule		MM MT Ferrule	
Polish		APC	PC	APC	PC	PC	PC	PC	PC
Insertion Loss(dB)	Typical	0.50	0.50	0.30	0.30	0.50	0.50	0.30	0.30
	Maximun	0.70	0.70	0.50	0.50	0.70	0.70	0.50	0.50
Return Loss(dB)		60	45	60	45	20	20	20	20
Exchangeability(dB)		≤0.3dB							
Durability(dB)		<0.2dB(500 Matings, per EIA-455-21A)							
Tensile Strength (dB)		≤0.3dB(Max 66N)							
Operating Temperature (°C)		-20 ~ +60							

Storage Temperature(°C)	-40 ~ +80
-------------------------	-----------

MT Ferrule (Male&Female)

12F

24F

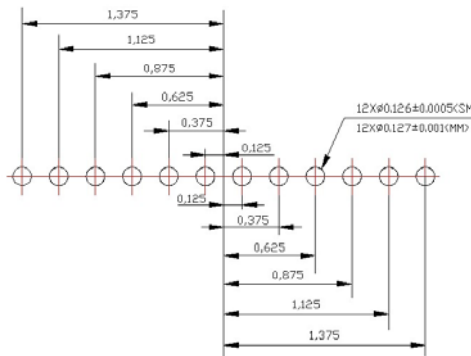
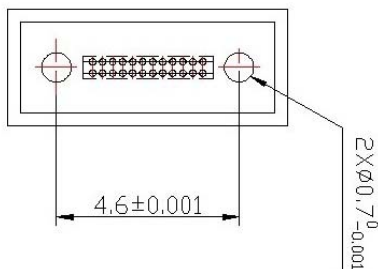
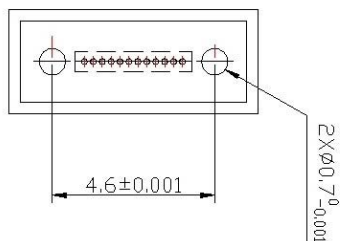

Cable type	Description
	<p>Round housing Kits Female and Male---Cable Boot, Crimp Ring, Spring Push, Spring, Pin Clamp Assembly(Female or Male),Housing Assembly</p> <p>MPO connector Length 60.2mm</p> <p>Cable Boot 3.0mm or 3.6mm</p> <p>Female & Male MM boots Color---Beige, Aqua, Black, White...Special</p> <p>Female& Male SM boots Color—Green, Yellow, Mustard.....Special</p>
	<p>Oval housing Kits Female and Male---Cable Boot, Crimp Ring, Spring Push, Spring, Pin Clamp Assembly(Female or Male),Housing Assembly</p> <p>MPO connector Length 45.6mm</p> <p>Female & Male MM boots Color---Beige, Aqua, Black, White...Special</p> <p>Female& Male SM boots Color—Green, Yellow, Mustard.....Special</p>
	<p>Bare Ribbon Housing Kits Female and Male---Cable Boot, Crimp Ring, Spring Push, Spring, Pin Clamp Assembly(Female or Male),Housing Assembly</p> <p>MPO connector Length 43.0mm</p> <p>Female & Male MM boots Color---Beige, Aqua, Black, White...Special</p> <p>Female& Male SM boots Color—Green, Yellow, Mustard.....Special</p>

MPO Communication Marks Division

Polarity A: Straight Through

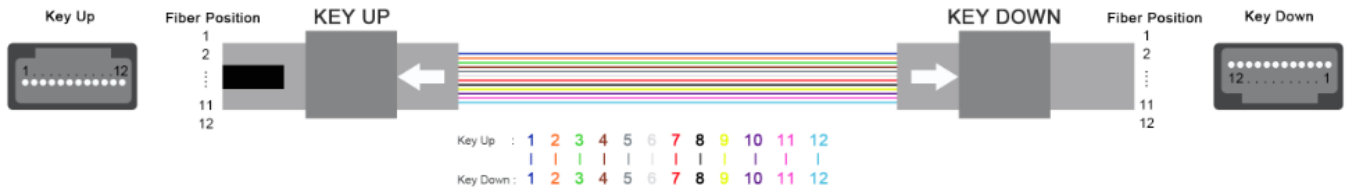

Polarity B: Cross

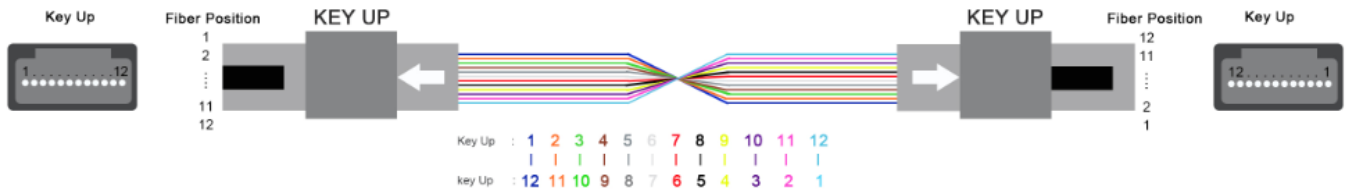

Polarity C: Cross Pair

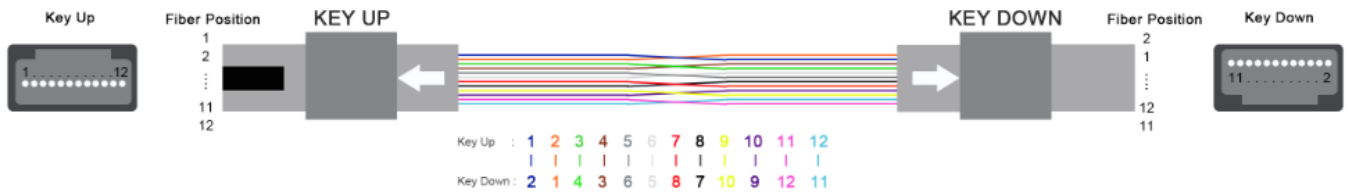

Ordering Information

X to X	X	X	X	X	X	X	X	X
Connector Type	MPO Polish	Housing Color	Fiber Type	Fiber Count	Cable Length	Pigtail length	Cable type	Polarity
1=MPO-Female	1=UPC	1=Beige	1=SM 9/125	1=8	0=0.5m	0=0m	1=Bare-Ribbon	A=Polarity A
2=MPO-Male	2=APC	2=Aqua	G652D	2=12	1=1.0m	1=0.5m	2=Oval	B=Polarity B
3=LC/APC	8degree	3=Green	2=SM 9/125	3=24	2=2.0m	2=0.6m	3=Round	C=Polarity C
4=LC/UPC		4=Yellow	G657A	4=48	3=3.0m	3=1.0m		
5=SC/APC		5=Black	3= MM 50/125 (OM2)	5=72	S=Specify	4=1.5m	S=Specify	
6=SC/UPC		6=Red	4=MM 50/125 (OM3)	6=96		5=2.5m		
7=FC/APC		S=Specify	5=MM 50/125 (OM4)	7=144		6=3.0m		
8=FC/UPC			6=MM 62.5/125 (OM1)	S=Specify		S=Specify		
9=ST								
0=MU								
S=Special								